

Power supply for community antenna

Type TU-P

Single-phase isolating transformer designed and tested according to norm EN61558-2-6.

Separate insulated windings, moulded in self-extinguishing Polyurethane and capsulated in plastic. Insulation class II, double isolated. Short circuit proof and protected against overload. Thermal protected (FI). Variable secondary output (42V – 48V). Equipped with 250V secondary terminals in case of extra high mains voltage. For Fixed installation, simple and easy mounting on wall or ceiling.

Applications:

Power supply for community-antenna. Designed for operating in environments with high ambient temperatures, max 55°C ($t_a=55^\circ\text{C}$). Galvanic partition between primary and secondary side. Protects installations and eliminate earth faults.



Technical specifications

- Input voltage: 0-230-250V
- Frequency: 47-63Hz
- Output voltage: 0 - 42 - 48V
- According to: EN61558-2-4
- Test/insulating voltage: 4kV AC RMS
- Construction class: II
- Insulation class: B (130°C)
- Ambient temp. (t_a): 55°C
- Degree of protection: IP44

Wiring diagram

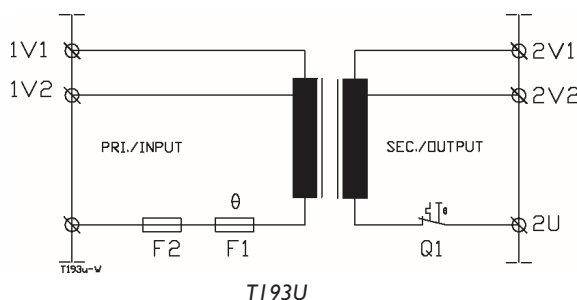
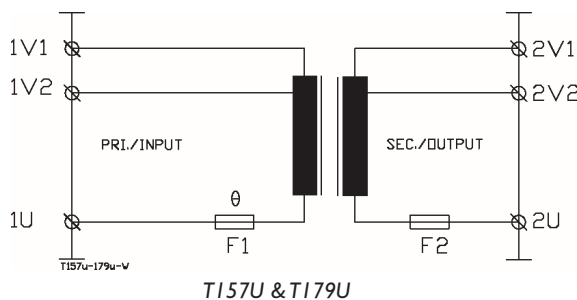
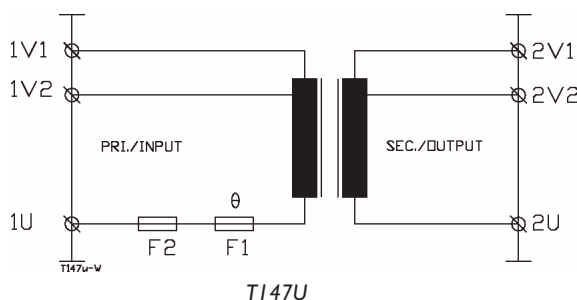

Dimensions

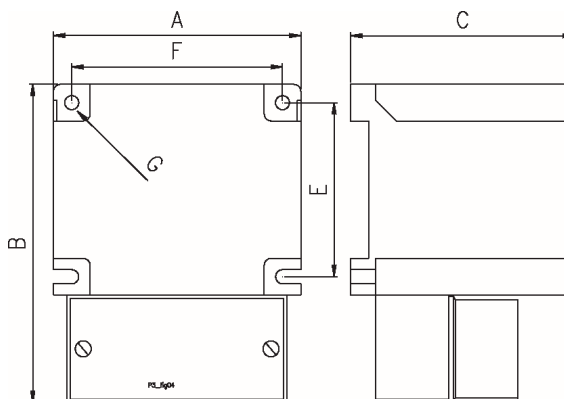

| Type | Voltage Sec. (V) | Power (VA) | Fuse Pri. | Fuse Sec. | Dimensions AxBxC (mm) | Weight (Kg) | Art. no. |
|----------------------------|------------------|------------|-----------|-----------|-----------------------|-------------|--------------|
| 0-230-250/0-42-48 V | | | | | | | |
| T147U-405P | 0 - 42 - 48 | 60 | T0,8A | - | 73x113x61 | 1,3 | 4-052-144405 |
| T157U-406P | 0 - 42 - 48 | 120 | - | T2,5A | 94x131x82 | 2,5 | 4-052-244406 |
| T179U-407P | 0 - 42 - 48 | 240 | - | T6,3A | 105x152x93 | 4,1 | 4-052-244407 |
| T193U-409P | 0 - 42 - 48 | 480 | T4,0A | 12A auto | 130x200x115 | 7,7 | 4-052-244409 |