

Vario®-isolating transformer

Type RGE

Capsulated single-phase Vario® transformer designed and tested according to VDE0570. Designed as a torodial isolating transformer with separate insulated windings and prepared for class II equipment. Degree of protection IP20. The Noratel Vario® transformer is an optimal solution when continuous control of voltage and current is preferable. The construction ensures a clean sine voltage and no radio interference or additional harmonics are generated.

Applications:

For continuous adjustment of alternating voltage and currents, where of safety reasons an isolating transformer with separate windings is required. In addition to standard types, Vario® variable transformers are supplied strictly on customer request.



Technical specifications

- Input voltage: 230V
- Frequency: 50-60Hz
- Output voltage: 0-230V
0-260V
- According to: VDE0570, IEC60989
EN61558-2-14
- Test/insulating voltage: 5kV AC RMS
- Construction class: II
- Insulation class: E (120°C)
- Ambient temp. (t_a): 40°C
- Degree of protection: IP00

Wiring diagram

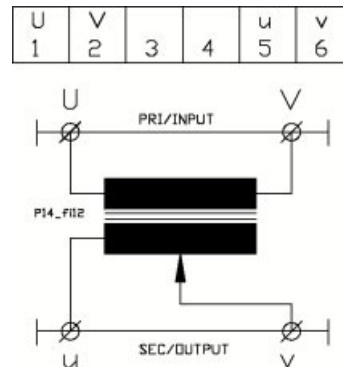

Dimensions 1 (mm)

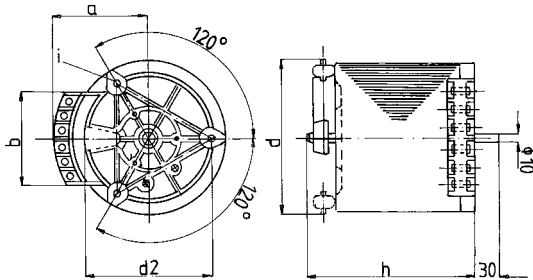

Dimensions 2 (mm)

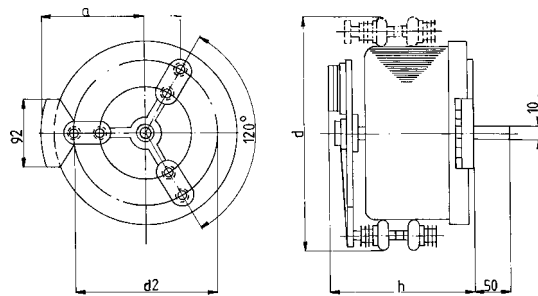

Standard types

Type	Voltage Prim. (V)	Voltage Sec. (A)	Max current Sec. (A)	Dimension drawing	Dimensions (mm)					Weight (Kg)	Art. no.
					a	b	d	d2	h		
RGE260/4	230	0-260	4	1	95	85	168	100	160	9,7	4-101-100406
RGE260/8	230	0-260	8	2	148	92	305	160	170	17,6	4-101-100806