

# Encapsulated autotransformer, IP20

## Type LFA

Single-phase short circuit proof autotransformer designed and tested according to EN61558-2-13. Portable design. Insulated windings moulded in self extinguishing Polyurethane and capsulated in plastic.

For fixed installation, simple and easy mounting. Short circuit protected with glass tube fuse and overload protected with "cut out" fuse on primary side.

### Applications:

Portable transformer for changing system voltage from 230 Volts to 115 Volts or vice versa.

### Technical specifications

- Input voltage: 115V, 230V
- Frequency: 50-60 Hz
- Output voltage: 230V, 115V
- According to: EN61558-2-13
- Test/insulating voltage: 2kV AC RMS
- Construction class: II
- Insulation class: B (130°C)
- Ambient temp. ( $t_a$ ): 40°C
- Degree of protection: IP20

### Wiring diagram

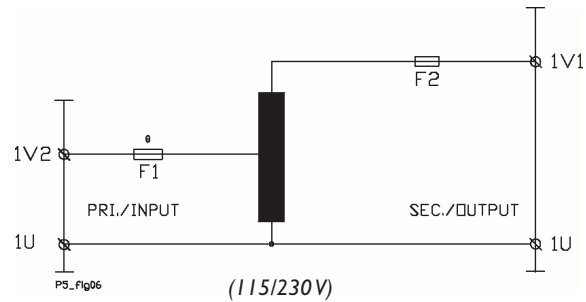
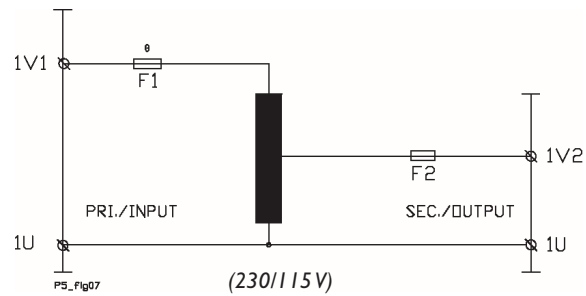

### Dimensions

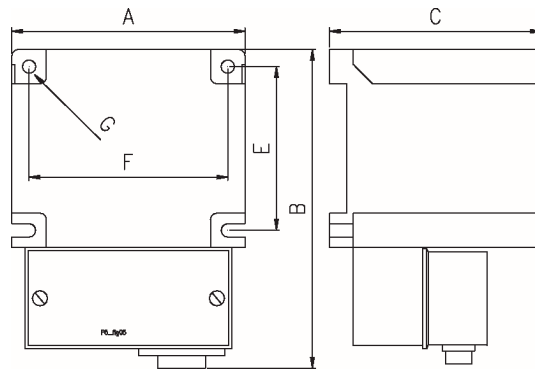

| Type            | Voltage Pri. (V) | Voltage Sec. (A) | Current (A) | Power (VA) | Dimensions AxBxC (mm) | Weight (Kg) | Art. no.     |
|-----------------|------------------|------------------|-------------|------------|-----------------------|-------------|--------------|
| <b>230/115V</b> |                  |                  |             |            |                       |             |              |
| LFA36-01        | 230              | 115              | 0,609       | 70         | 66x93x59              | 1,2         | 4-058-120071 |
| LFA157-01       | 230              | 115              | 2,09        | 240        | 92x130x87             | 2,6         | 4-058-120241 |
| LFA179-01       | 230              | 115              | 4,17        | 480        | 106x153x98            | 4,2         | 4-058-120481 |
| LFA193-01       | 230              | 115              | 8,35        | 960        | 130x202x115           | 7,8         | 4-058-121001 |
| LFA218-01       | 230              | 115              | 15          | 1720       | 162x235x140           | 15,1        | 4-058-121801 |
| <b>115/230V</b> |                  |                  |             |            |                       |             |              |
| LFA150-04       | 115              | 230              | 0,65        | 150        | 83x108x78             | 1,8         | 4-058-120154 |
| LFA157-04       | 115              | 230              | 1,04        | 240        | 92x130x87             | 2,6         | 4-058-120244 |
| LFA179-04       | 115              | 230              | 2,09        | 480        | 106x153x98            | 4,2         | 4-058-120484 |
| LFA193-04       | 115              | 230              | 4,17        | 960        | 130x202x115           | 7,8         | 4-058-121004 |
| LFA218-04       | 115              | 230              | 7,4         | 1700       | 162x235x140           | 15,1        | 4-058-121804 |